

OPTION 1

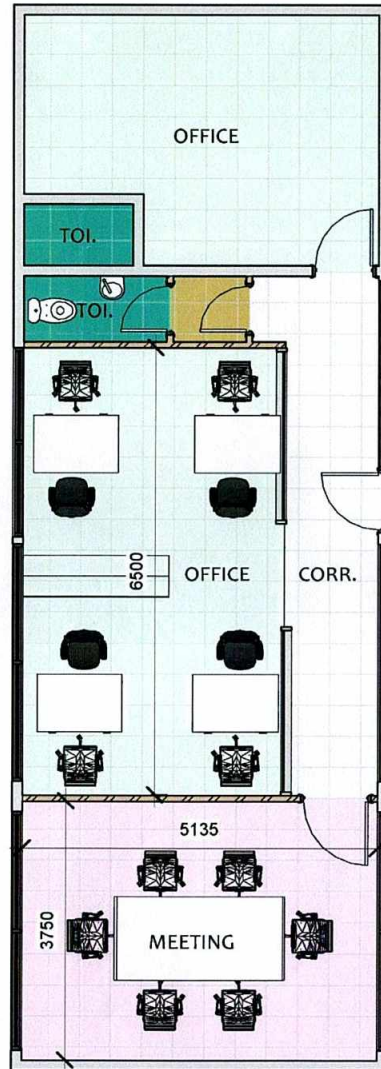

GENERAL SCOPE OF WORKS

1. REPLACEMENT OF ALL ALUMINIUM SLIDING WINDOWS AND DOORS
2. REMOVAL OF EXISITING FLOOR TILES
3. DRY WALL PARTITIONING
4. GLAZED PARTITIONING
5. CREATION OF UNISEX WASHROOM
6. PLASTERBOARD/GYPSUM CEILING
7. LED LIGHTING
8. DATA AND RE-WIRING
9. NEW AIR CONDITIONING FIXES
10. WATER TREATMENT AND ASSOCIATED PLUMBING WORKS
11. PAINTING
12. EXTERNAL WORKS

OPTION 2

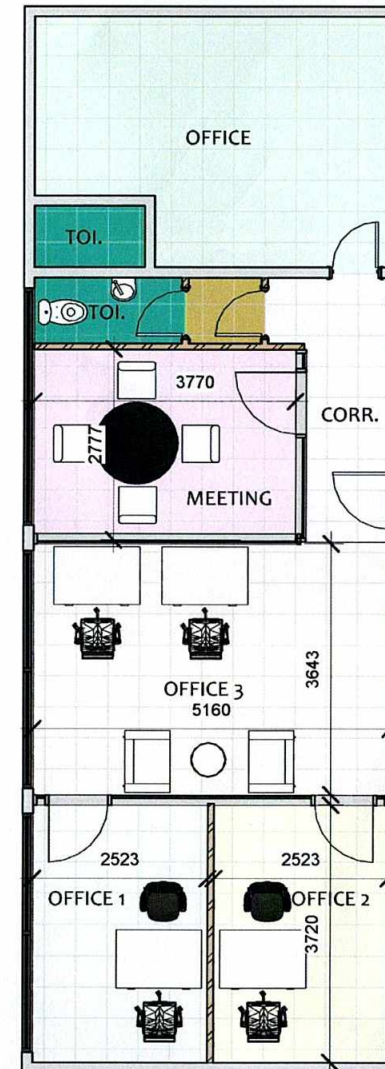

1

00 Ground Floor

1 : 75

